

# **Armstrong**

**MARINE USA INC.**

## **2910-CTC**



### **Specifications**

- **Hull Size:** Length 29': Beam 10'
- **Hull Type:** Classic tunnel catamaran
- **Superstructure:** Fwd leaning full width cabin w/ cuddy
- **Fresh water:** 25 US gal
- **Black water holding tank:** 25 US gal
- **Fuel Range:** 100-150 US gal
- **Accommodation:** Head & galley
- **Electrical:** 12V DC electrical system
- **Outboard Range:** 200hp - 250hp
- **Steering:** SeaStar EPS electronic steering

### ***FIRST IN CATAMARANS***

Our legacy of custom aluminum catamarans began in the 1990s and has evolved into a tradition of boats uniquely designed for adventure. We combine our multi-hull experience with the distinct requirements of each owner to construct a custom vessel tailored to perform its purpose. Join our heritage of innovation with a new Armstrong catamaran.

**Safety | Stability | Speed**

**Armstrong Marine USA, Inc.**  
151 Octane Lane  
Port Angeles, WA 98362  
Tel: (360) 457-5752  
[www.armstrongmarine.com](http://www.armstrongmarine.com)



## 2910-CTC Base Model Specification

### ARMSTRONG MARINE HULL

- Length 29': Beam 10'
- 5086 alloy aluminum hull skins
- 5052 alloy aluminum interior transverse frames
- Longitudinal t-bars
- Longitudinal hull stiffeners
- Floor framed on 26" centers
- Self bailing aluminum decks

### Deck Accessories

- Extended T-transom c/w webbed nylon gate
- Hand rails fore & aft deck
- Aft folding radar & antenna mast
- Side boarding door (stbd)
- Hull access hatches c/w gas strut
- (2) Fish storage lockers self draining
- (2) Battery lockers c/w hinged doors, vents & drainage ports
- (2) Freeman 12" round liftout hatches in outboard well
- (6) 11" tie up cleats
- 8" tie up cleat
- Bow roller
- Anodes for cathodic protection

### FWD LEANING FULL WIDTH CABIN C/W CUDDY

- Walls & ceiling insulated & paneled w/ white FRP
- Overhead grab rails along centerline
- Lonseal vinyl flooring over Coosa composite subfloor
- Welded aluminum dash console c/w painted removable lower cover panel

### Cuddy

- Berth c/w gray hull liner finish
- Mattress covered w/ Ballistic nylon
- Lewmar 60 low profile hatch

### Head

- Electric marine toilet (fresh water flush)
- Solar powered exhaust fan
- Watertight toilet paper holder
- Teak framed mirror (wall mounted)

### WATER SYSTEM

- 25 Gallon fresh water tank c/w deck fill & vent
- 25 Gallon black water tank c/w Y valve w/ macerator & deck pump out

### Bilge

- (2) Rule 2000 bilge pumps w/ float switches & high water alarm

### WINDOWS & DOORS

#### Windows

- All Windows .25" commercial grade glass c/w powder coated mitered frames
- (3) Windshields clear
- (2) Sliding side windows tinted
- (3) Fixed side windows tinted
- Fixed window for aft cabin bulkhead clear
- Opaque sliding window in head compartment tinted

#### Doors

- Sliding door c/w tinted window & SS lockset
- AMUSA hinged door for head compartment c/w privacy lock & 3 coat hooks

### ELECTRICAL SYSTEM

#### DC Electrical System

- Battery pack - (2) group 31 starts & (1) group 31 house
- Blue Sea battery switches & ACR's
- 12V power outlet
- 12V dual USB port
- 12V Caframo Bora 748 fans
- Surface mount 187 Series circuit breakers
- LED navigation lights
- (5) LED red/white cabin lights
- Pantographic windshield wipers c/w washing system
- DC distribution panel
- Bilge pump panel switch

#### ELECTRONICS & NAVIGATION

- AFI premium electric trumpet horn
- Ritchie Explorer B51 magnetic compass

### POWER & PROPULSION

#### Engines, Controls & Steering

- Recommended power: 2X 200-250HP outboards
- Main station controls
- Optimus EPS core steering pack
- (2) Smartcylinder steering rams & pumps
- Electronic helm front mount
- "Destroyer" style 15.5" steering wheel c/w maneuvering knob

#### FUEL SYSTEM

- Twin fuel tanks w/ Wema fuel sending units
- EPA compliant fuel tanks & fills

#### SAFETY PACKAGE

- Type B-1 fire extinguisher ABC (5lb)
- Marine carbon monoxide detector (MTI 65-541)
- Xintex G-2BB-40 gasoline fume detector 2 ch w/ auto blower test
- Smoke detector

#### PAINT & FINISHES

- Clear coat protective finish
- Zolatone interior paint
- Durable non-skid deck coating
- Vinyl striping & decals (black, blue, green or red)

PROPOSAL - NOT FOR CONSTRUCTION

OPTIONAL EQUIPMENT MAY BE SHOWN

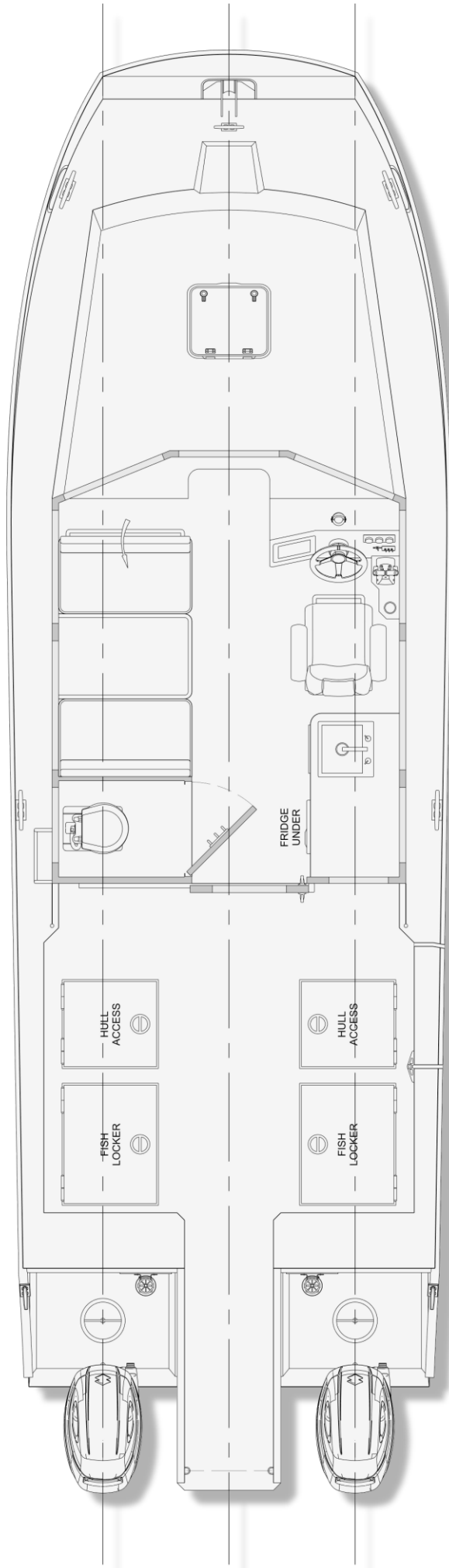

## 2910-CTC Full Width Cabin

PROPOSAL - NOT FOR CONSTRUCTION

OPTIONAL EQUIPMENT MAY BE SHOWN

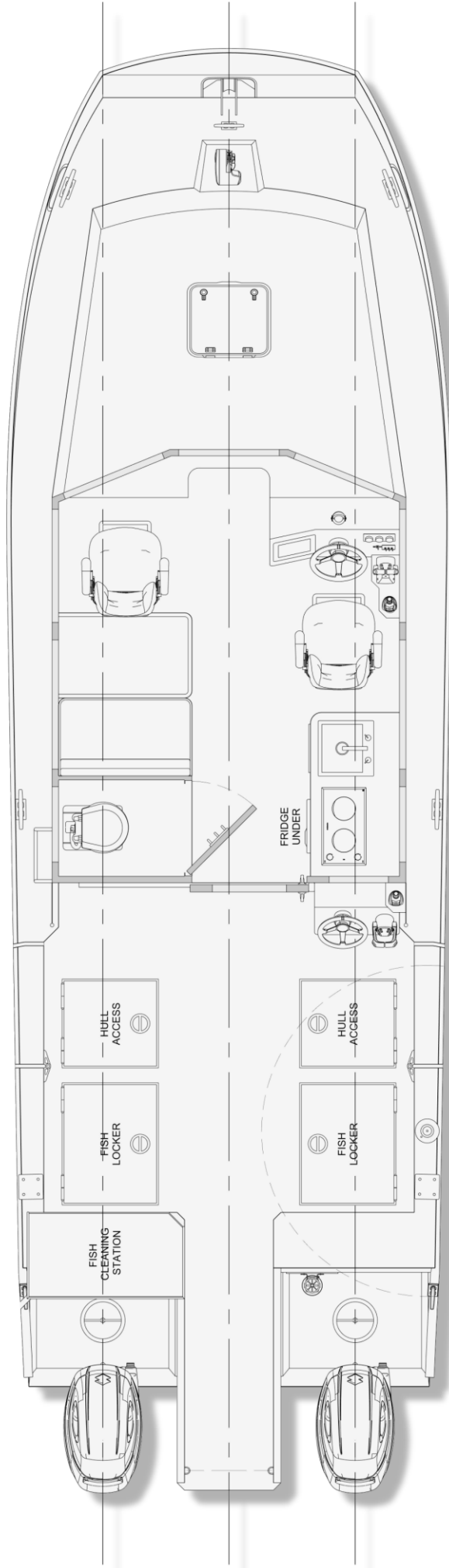

## 2910-CTC Full Width Cabin